

Ripple Chamber

Inability to listen is a problem faced by modern democracies. Citizens scream their views in protest, only to be heard by the likeminded. Partisan media breeds distrust and polarization. Dissenters are labeled as evil and dismissed without discussion. Those in power are inaccessible to the masses.

Our team's address to this year's design challenge put forth within the CCA Interuniversity Charrette is a design which facilitates the transformation from protest to dialogue. This is done by limiting entry space and breaking up a large open room using columns and amphitheatre like spaces. Through these amphitheatre spaces, we offer the public a chance to float between varying speakers and assemblies. Different groups will confront and compete with one another, fostering discussion, accountability, and compromise. In addition, mixing direct lighting through the use of light fixtures and diffused lighting through the use of a transparent roof and a light permeating membrane gives a soft and warm feel to the interior; an aspect which would help somber the atmosphere of the space.

The chosen site for our build is right on Parliament Hill, where the East Block currently resides. This is no better site to use for a building which is meant to connect the people of this country directly to our political leaders. While designing our contemporary building, our team did not want to forget the architectural history of the building it replaces. We attempted to incorporate the Neo-Gothic style into our design. There are several references to this style within our design. The first and most obvious reference can be seen in the doorways, they are inspired by traditional Gothic-style entry doors. The next reference can be found within the angled columns of our structure. We began with the idea of a traditional, pointed archway and added a technology-driven, modern interpretation of the pointed arch. The final reference we wanted to add to our building is one which is more imaginative at this stage. This reference is Canadian history through sculptural relief. This relief would cover the exterior walls, depicting various Canadian and Aboriginal images created by an artist. This seemed like a fitting idea for a building such as this, cladding Canadian history on a building where Canadian history will be made.

This building would stand as a monument to how Canadians handle their democratic rights. It will stand as a place for people to come and respectfully start the conversation for social, political and economic change. This place breaks apart the mass which a protester hides behind and invites individuals to have a face within the discourse of Canadian politics. This design is a building for the people and for the political leaders, standing as the platform for citizens to once again be the demos of democracy.

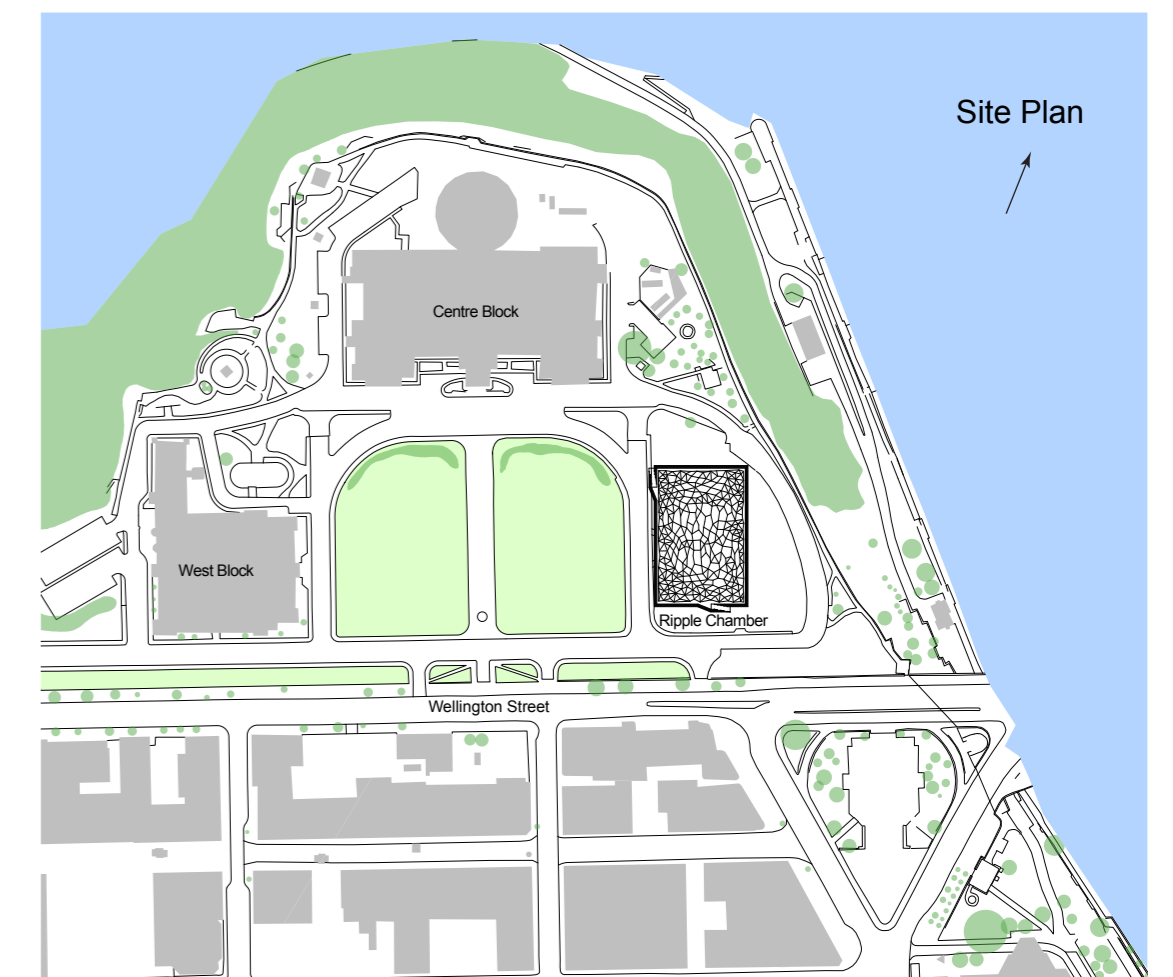

Plan

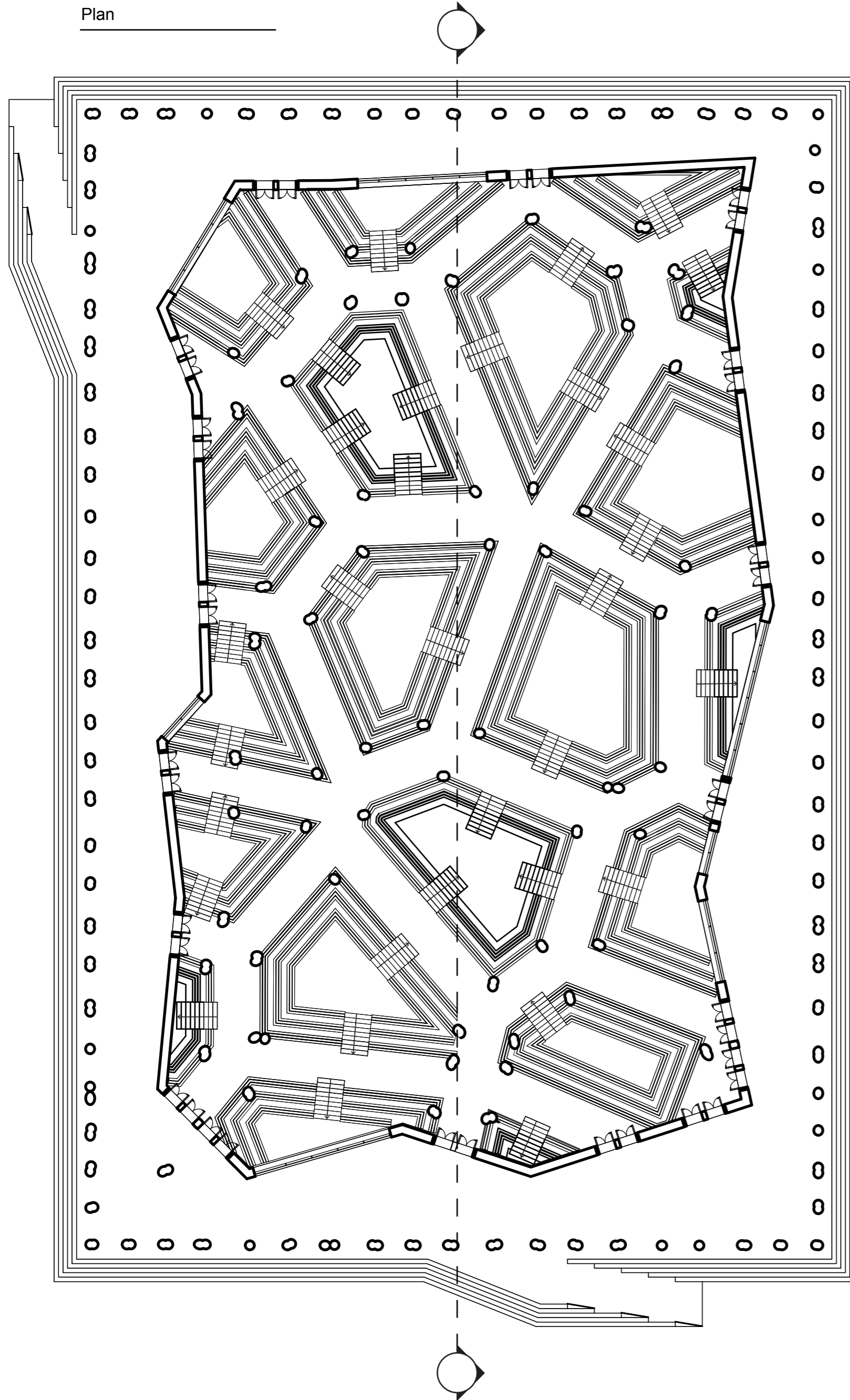

Axonometric

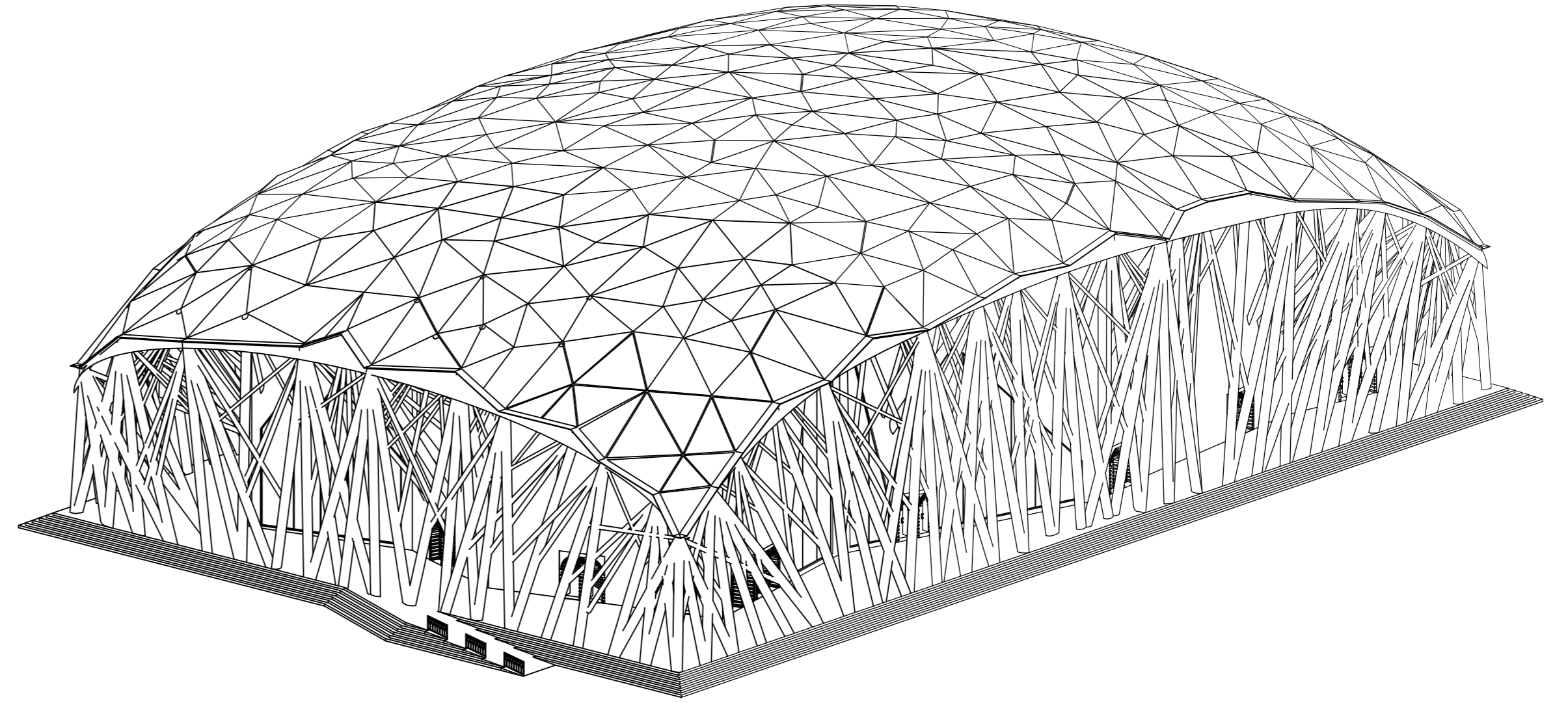

Section

Light-permeating, sound damping membrane



Amphitheatre