

PROYECTO RICA 18

POST DISASTER RELIEF KIT

Costa Rica has a population of 4.5 million; of these more than one million live in poverty. More than 52% live in inadequate houses or settlements after natural disaster incidents have hit the coastal and major parts of the urban fabric.

More than 7,000 houses in the country do not have proper water supplies. An estimated 46,000 houses use charcoal or wood burning stoves for their cooking. Approximately 1,500 homes don't have access to any energy source what so ever. Over 6,000 homes have no electricity supply.

Nearly 7,300 homes have dirt floors.

About 20,000 households have pit toilets instead of full bathrooms.

As it becomes possible to change their conditions, their behavior improves naturally. There is a shelter for the homeless of San Jose that most certainly is changing conditions. The shelter is in the "red zone" of the capital. It opens from 6pm-6am, on the second floor of a commercial building, in an area not many dare to pass at night. Each night, it receives 102 people who are homeless. There, the people are treated with dignity, respect and affection. They are given a clean bed, shower, pajamas, a locker, appreciation, dinner, breakfast and supplies like toothpaste and talc.

Those who have found jobs or began studying are given a fixed place in the shelter. The rest of the spots are rotated among those in need. Women enter first, followed by seniors and the disabled. The rest of the men are not always so lucky. If they don't get a spot one day, they are given priority the next.

One or more issues may be the cause for an individual's housing problem.

- Few jobs opportunities available
- Lack of access to healthcare; can't afford it, unaware care is needed or chronic condition not covered by Government sponsored program thus preventing person from working.
- Natural Disasters, including but not limited to flooding, earthquakes and hurricanes
- Mental disorder where mental health services are unavailable or difficult to access
- Disability, especially where disability services are non-existent or poor performing
- Social exclusion because of sexual orientation and gender identity
- Substance abuse
- Lack of affordable housing
- Domestic violence or relationships breaking down (couples or parents/children)

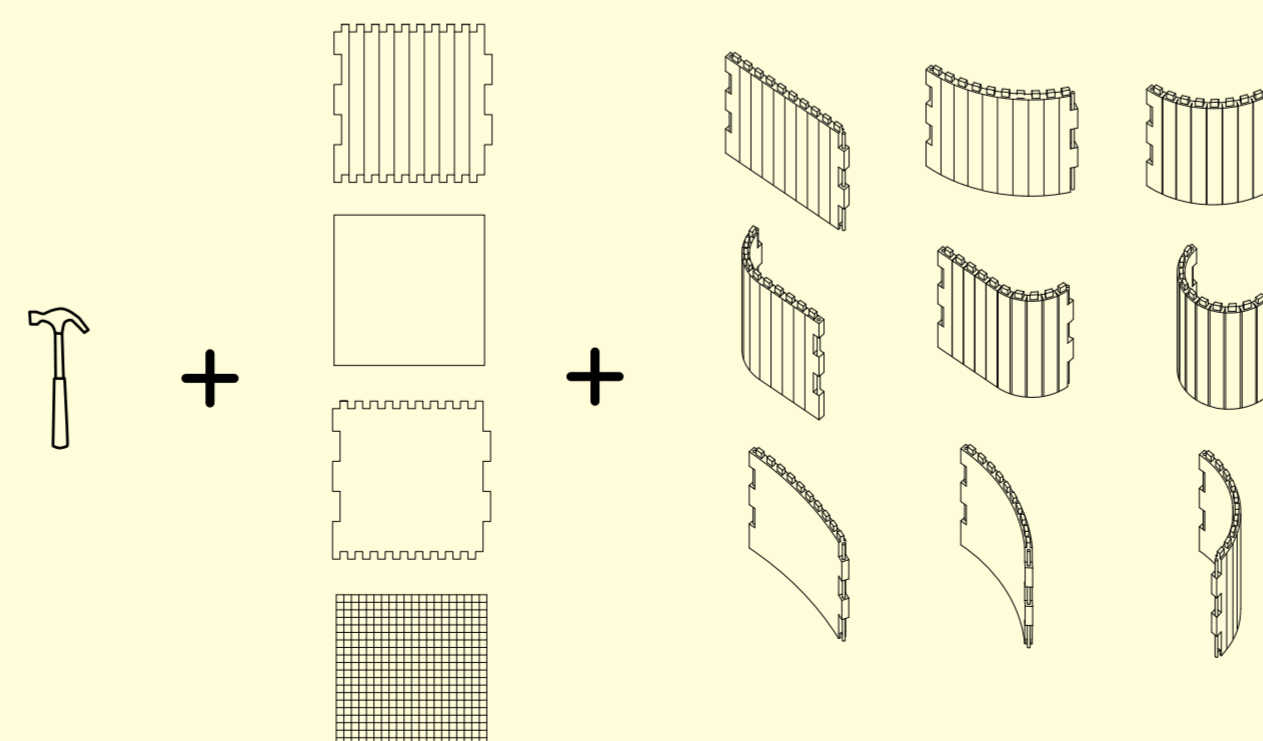
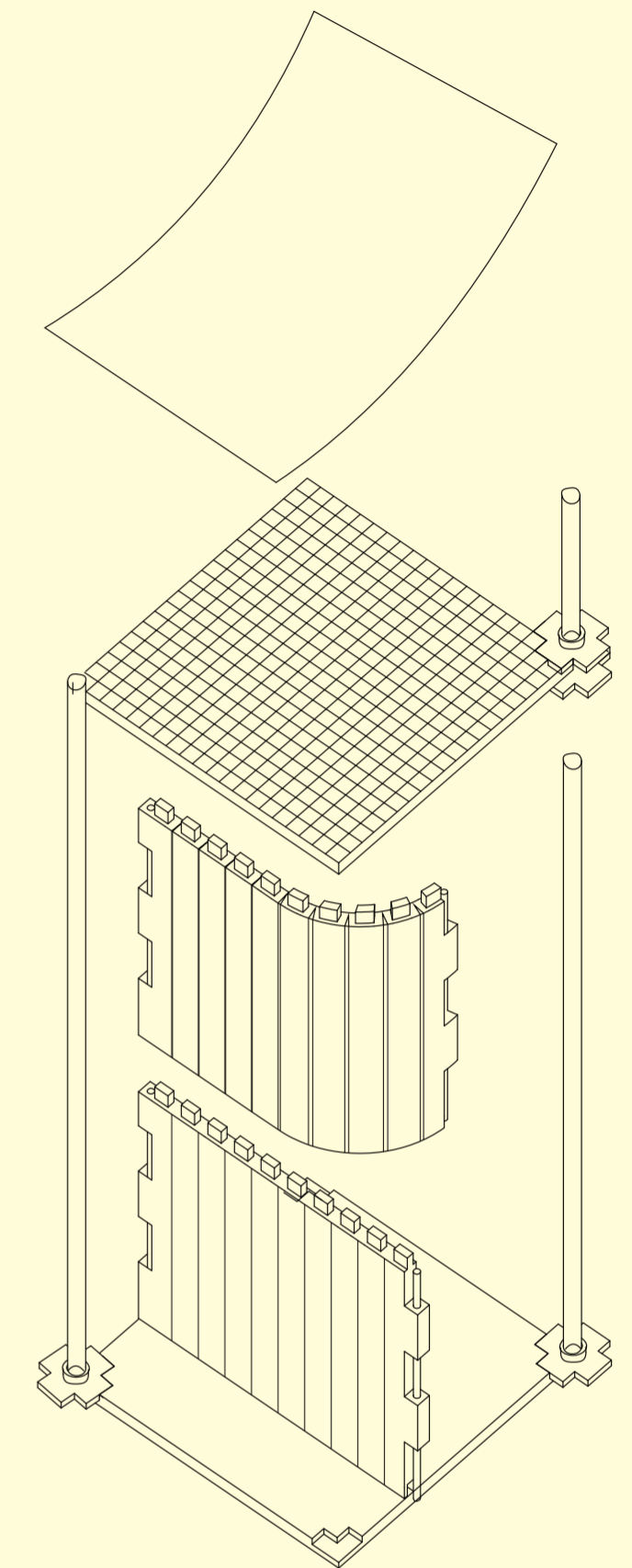

MATERIALS:

- 6ply (6cm) corrugated cardboard
- 1cm acrylic (exterior/interior coat)
- PVC 5cm diameter pipes
- Particle board 1x1m tile (roof&floor module)
- Acrylic Tarp

*extra components in order to assemble.
CNC mill to align floor plan slots accordingly to need.

+ Hammer

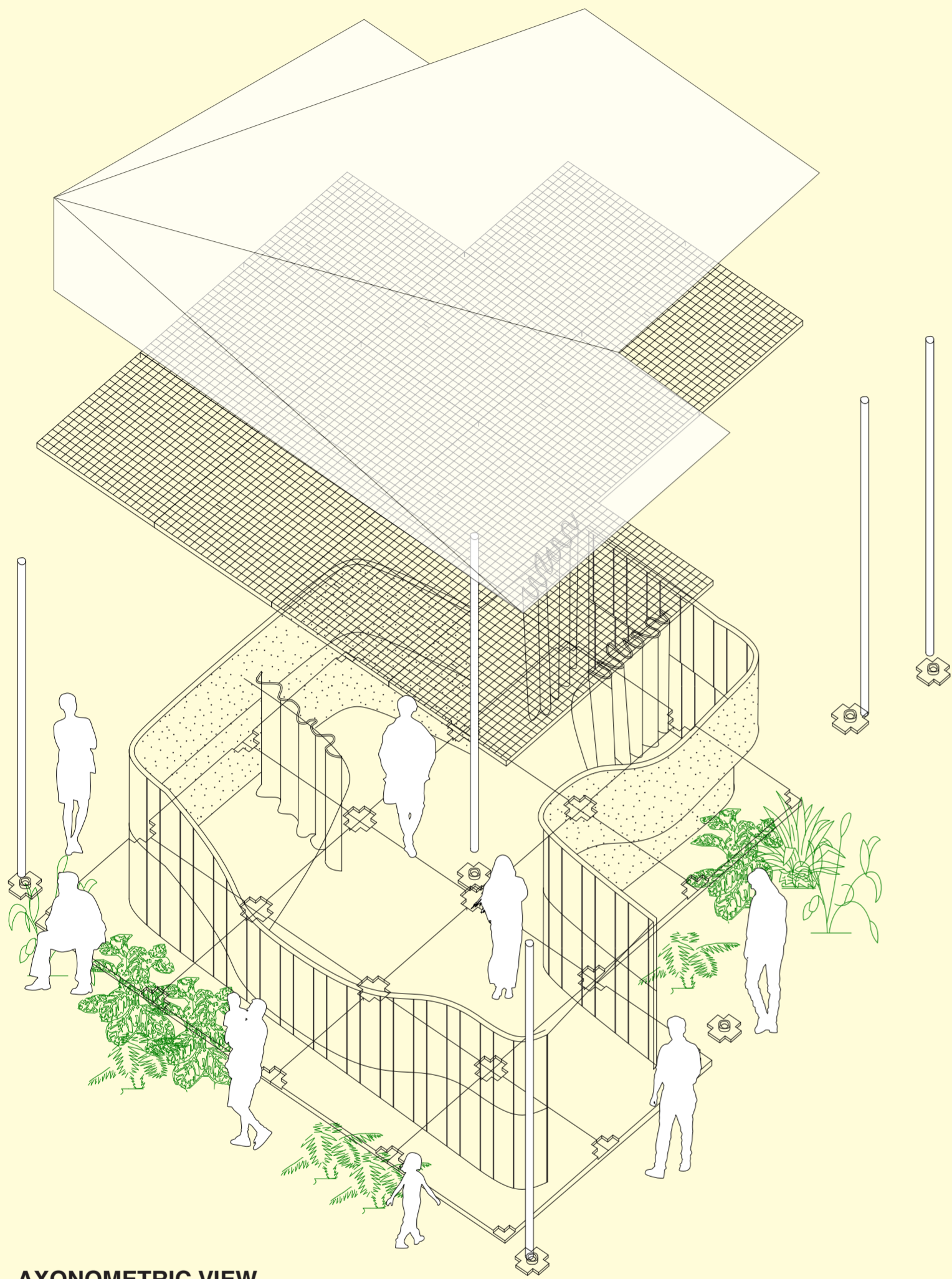

AXONOMETRIC VIEW

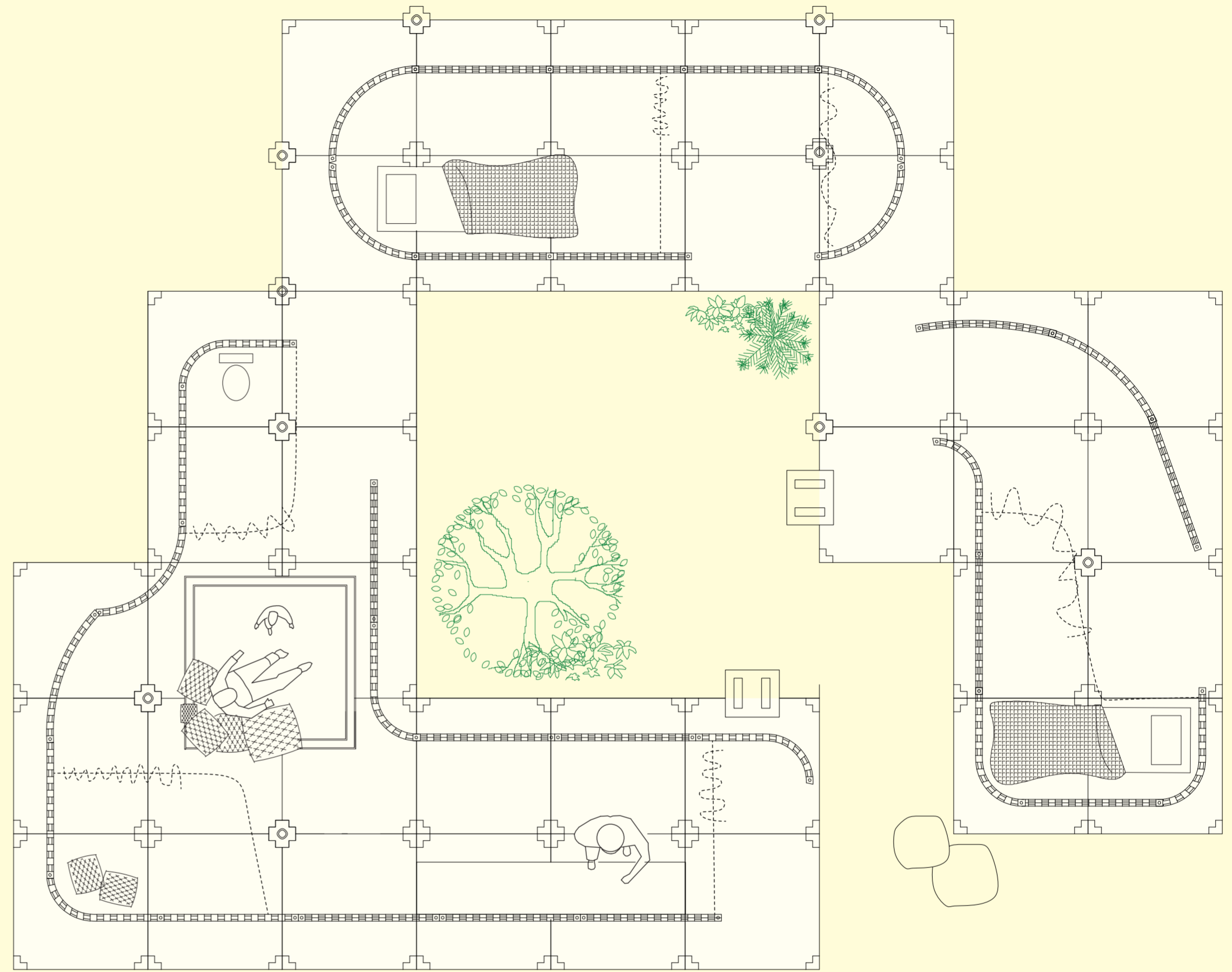

PLAN