

# LEVEL

Level proposes a space to be used for 24 hours that creates a vibrant outdoor community in the infill spaces under overpasses. Suspended below the overpass sits a community of modular affordable housing units in one of the most expensive neighborhoods in Vancouver. This project proposes drawing in low income workers from around the region and providing them with access to employment opportunities that are otherwise unavailable remotely.

Modular in design, the structure can expand to accommodate a growing number of inhabitants. Each prefabricated module is equipped with essential living necessities and erected on to the existing site. The structure then illuminates the park underneath, allowing night workers to have the same outdoor amenities that day workers have.

This proposal intends to demolish the rigid social framework of the city and attempts to level the playing field providing more opportunities to the less fortunate and creating a positive social and economic change.

*“Level” propose un espace accessible pendant 24 heures et crée une communauté dynamique extérieur sous les viaducs dans les espaces de remplissage. Une communauté de logements modulaires se situent sous les viaducs dans une des régions les plus chers de Vancouver. Ce projet propose attirer les travailleurs à faible revenu de la région et leur donner accès a des opportunités d’emploi qui, autrement, ne seraient pas disponibles à distance.*

*De conception modulaire, la structure peut être modifiée pour accueillir un grand nombre d’habitants. Chaque module préfabriqué est équipé avec des nécessités vitales essentielles et est construit sur le site existant. Pendant la nuit, la structure illumine le parc en dessous, et permet aux travailleurs de nuit d’avoir les mêmes commodités que bénéficie les travailleurs de jour.*

*Cette proposition vise aussi à démolir le cadre social rigide de la ville en offrant plus d’opportunités aux moins fortunés et en créant un changement social et économique positif.*

## income disparity

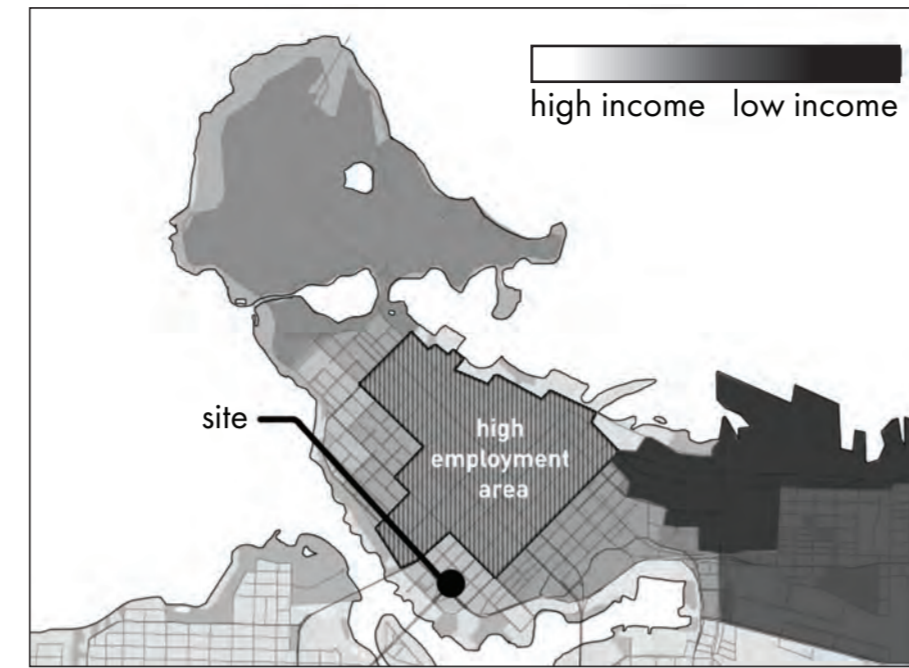

as visualized above, the city of Vancouver is infamous for its large economic disparities and gaps in household incomes

## urban reallocation

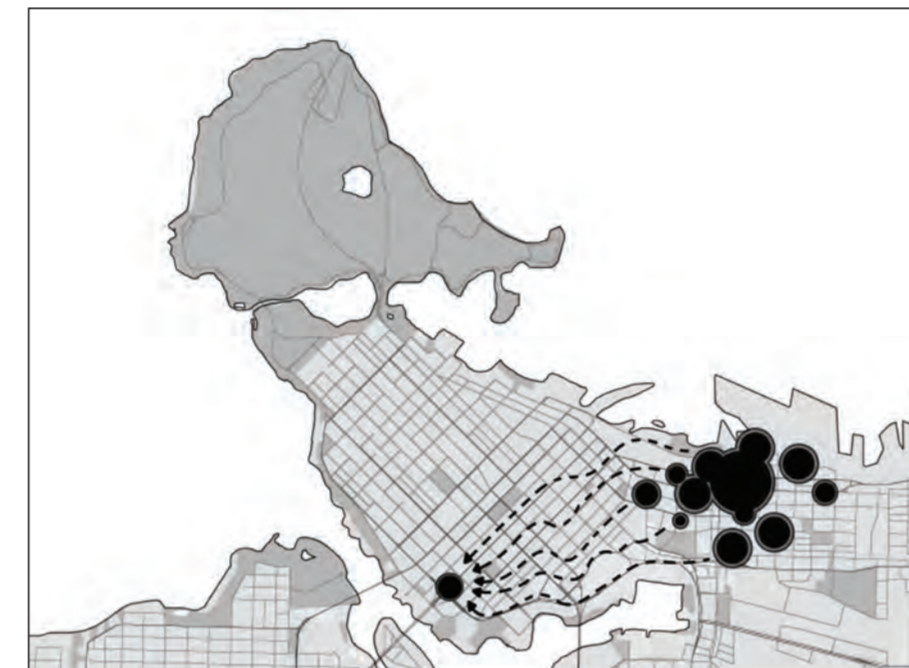

given the downtown area makes up for 34% of the jobs in Vancouver, moving the low income workers to the high income city center creates an equal opportunity for those in the lower classes



dayworker rests during the night



dayworker leaves for work while the nightworker returns

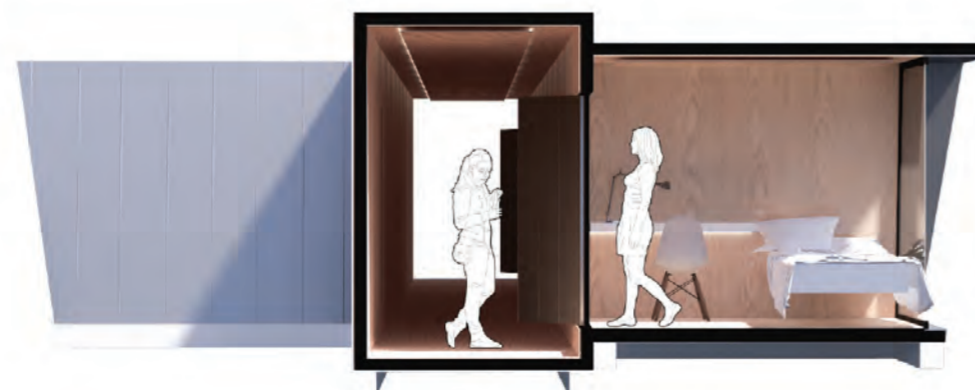

nightworker rests during the day

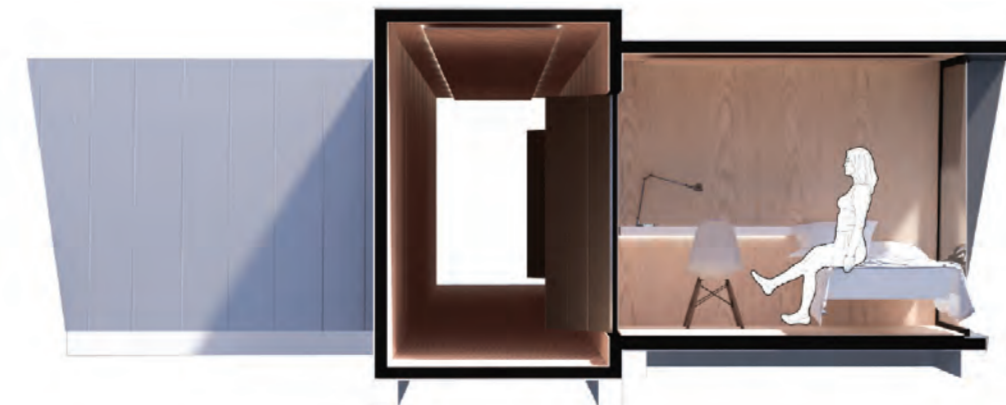

nightworker leaves for work while the dayworker returns



1 2 3 4 5 6 7 8 9 10 11 12 13 14 15 16 17 18 19 20 21 22 23 24

hours



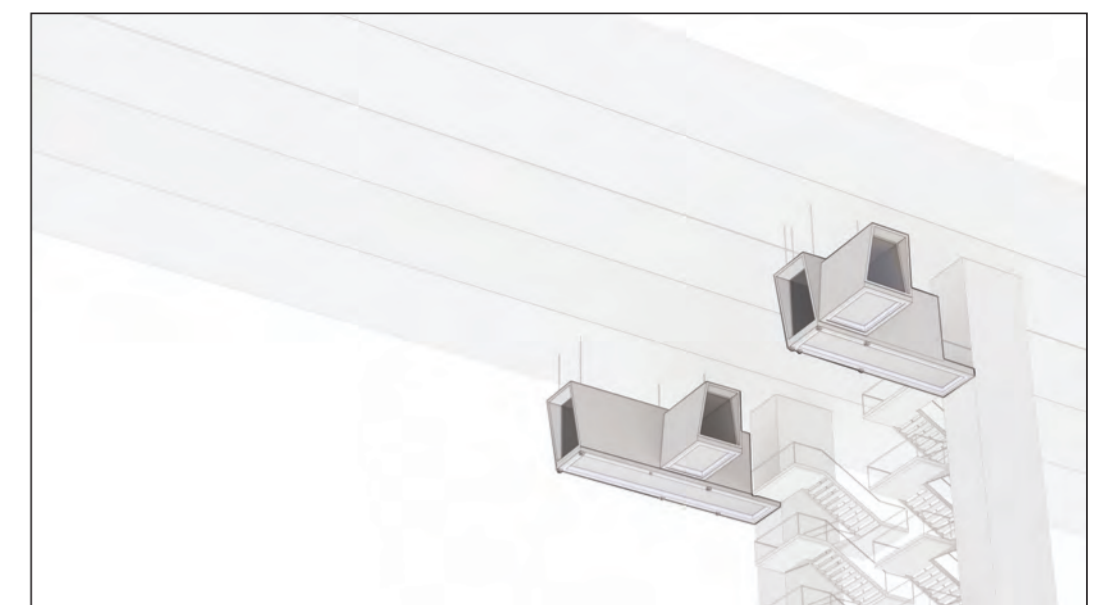

stairs and arterial modules installed

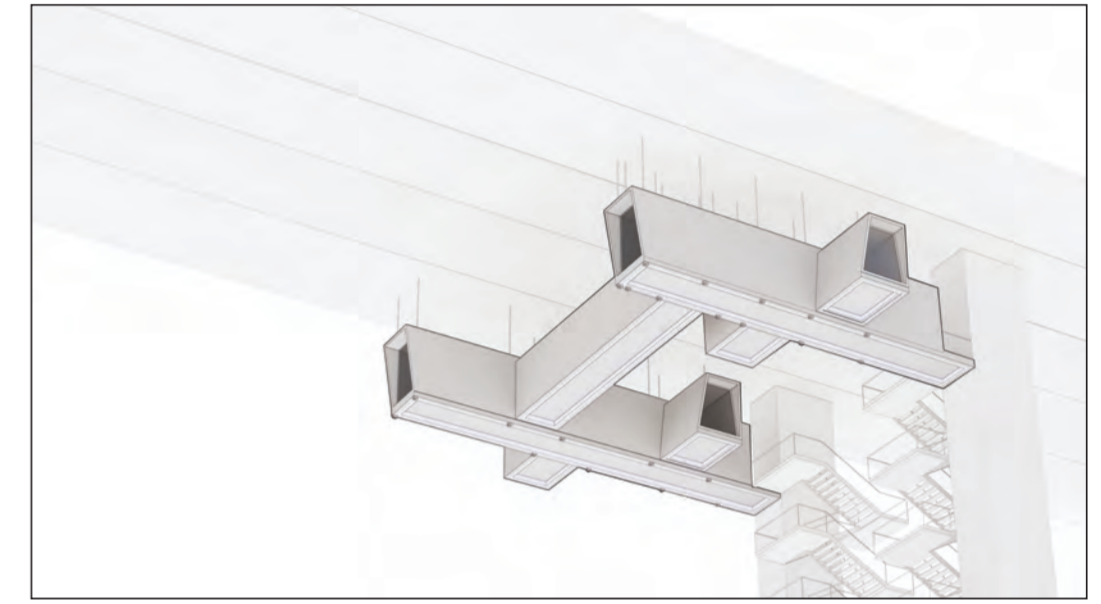

arteries connected and more modules installed

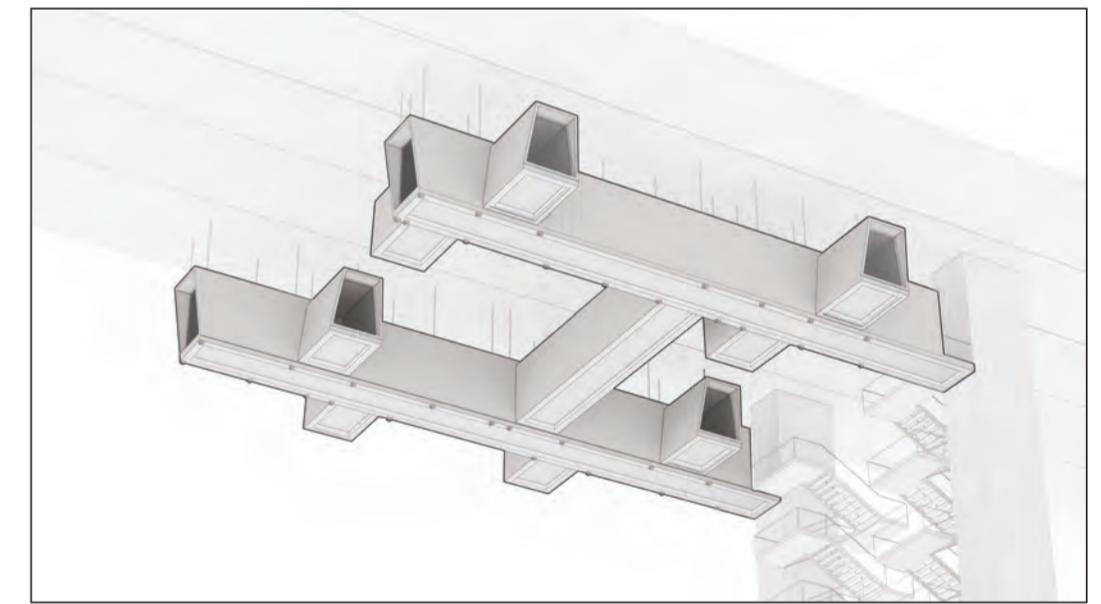

additional modules installed

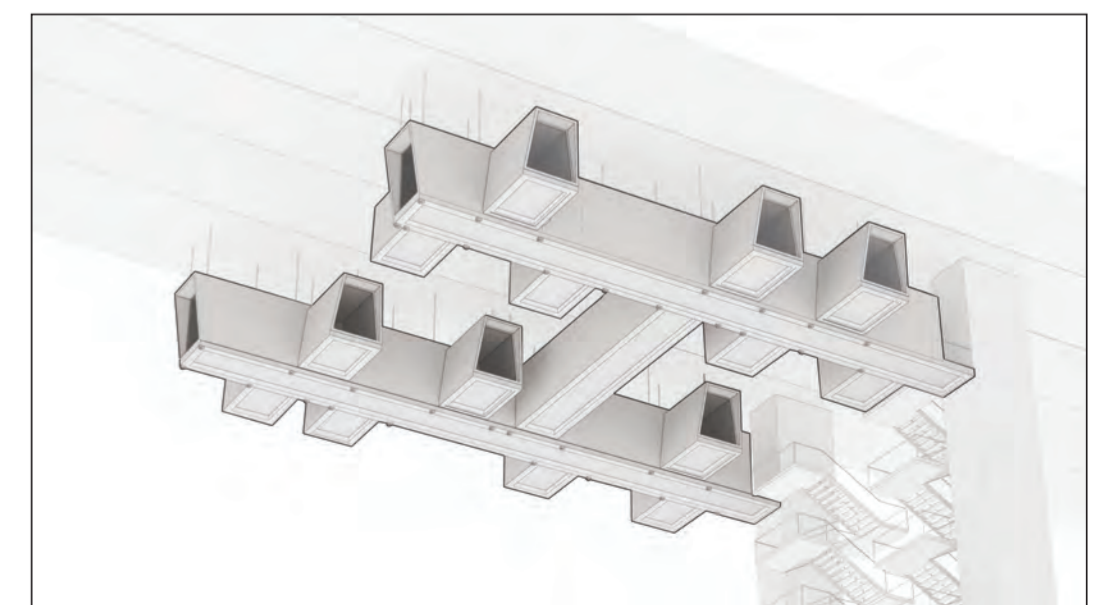

further expansion possible

**module connection**

- ① steel tension rod
- ② angled pin connection
- ③ welded pin connection
- ④ HSS support frame

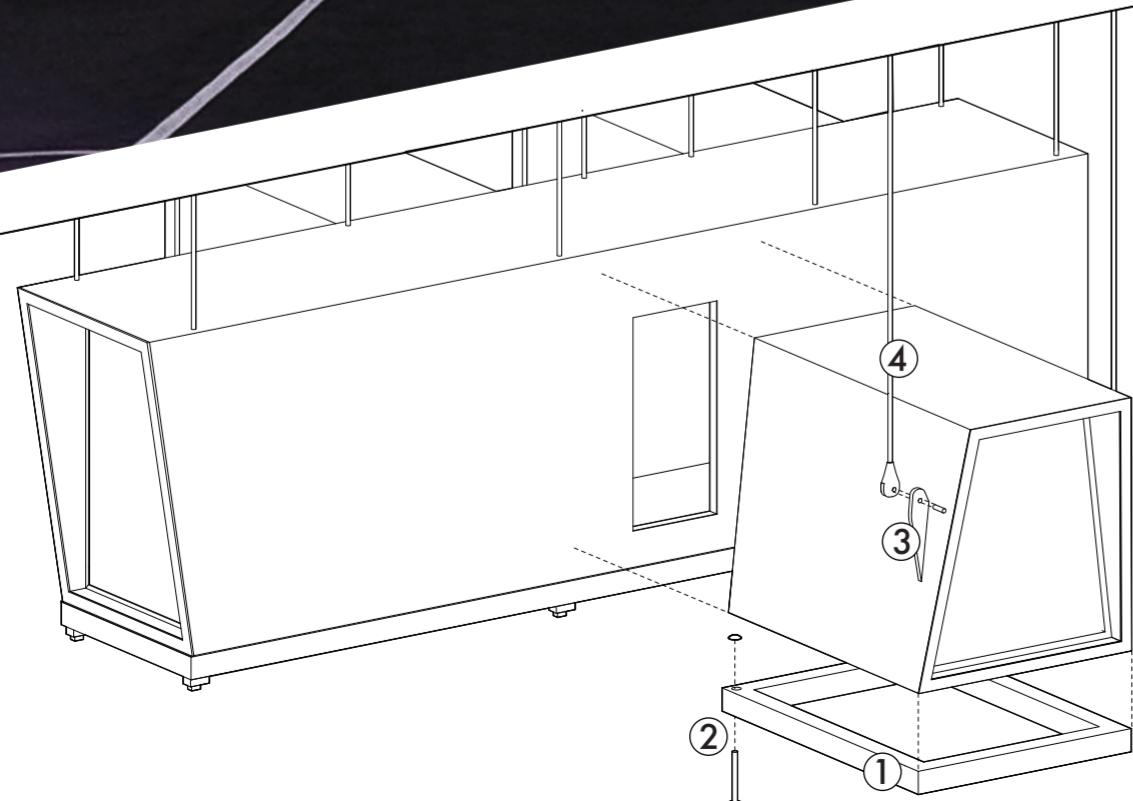

**construction assembly**

- ① steel cladding panels
- ② insulation/sound-proofing
- ③ steel studs
- ④ HSS support frame
- ⑤ aluminium frame
- ⑥ double glazed window

